

L O F T

## SB100: Video Sound Bar

### User Manual



## Table of Contents

Safety Warning and Precautions.....	3
Statement.....	4
Included Accessories.....	4
Product Function.....	4
Mounting Options.....	6
Quick Start.....	7
Federal Communication Commission Interference Statement.....	7
FCC Caution.....	7
IC Radiation Exposure Statement for Canada.....	8
7668 RF & Power.....	8
8821 RF & Power.....	9

## Safety Warning and Precautions

Before using and operating this device, please read thoroughly and comply with the following precautions in order to prevent accidents or abnormal operation.

### 1) Operating Environment

- Do not place the product in dusty and humid environments in case of internal short circuit.
- Do not place the product near heating devices (such as electrical heaters).
- Operating temperature is 0-40°C, operating humidity is 10%-90%RH. Please use the product accordingly.

### 2) Children Safety

- The product and accessories may contain some small parts. Please keep them away from children to avoid accidental swallowing or danger.

### 3) Power Supply

- Please use the standard power adapter provided with the unit.

### 4) Keep Dry

- The product is NOT waterproof. Please keep it dry.

### 5) Maintenance

- Please contact technical support for any maintenance services.
- Please do not insert any sharp or pointed object into the device.
- Prevent the device from falls and collisions with other objects, which may cause damage.

## Statement

- 1) Patents cover the hardware design and software of this product. Anyone who reproduces the product or the contents of these instructions without prior written permission from the company shall be liable to legal prosecutions.
- 2) The description, illustrations, etc. in this document may be subject to change, per the latest product specification and performance.
- 3) The included product images are for illustrative purposes only and may slightly differ in appearance, colour, size, etc. from the actual product.
- 4) The company reserves the rights to improve and change the appearance and design of the product without notice.

## Included Accessories

The following items are included in the product box:

- HDMI cable x1
- USB cable x1
- Battery x2
- Camera cover x1
- User Manual x1
- Wall-mounted components x1
- Power adapter x1
- Remote control x1
- Warranty card x1
- Quick Use Guide x1

## Product Function

Please familiarize yourself with the interface and buttons of the device before using.

# LOFT

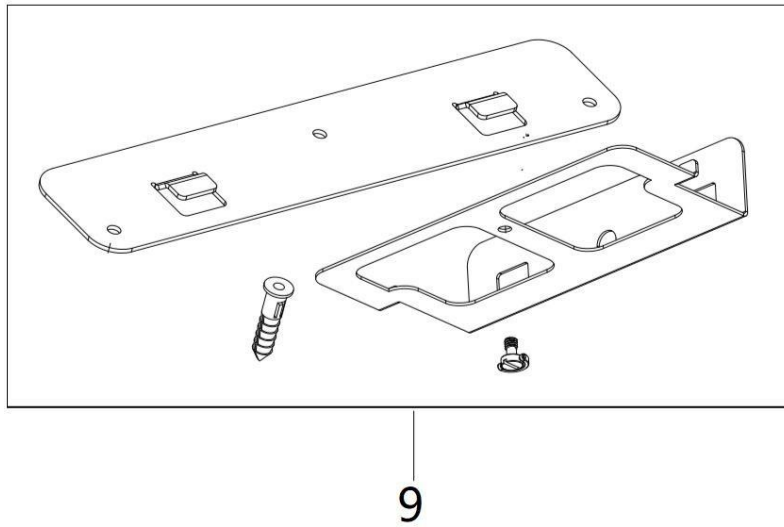
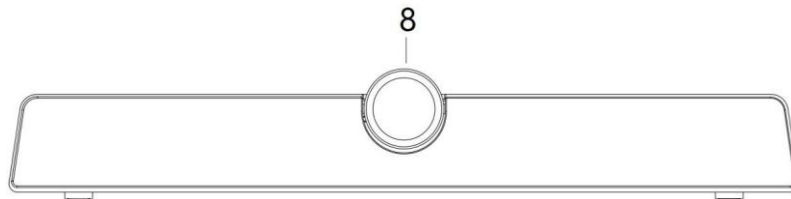
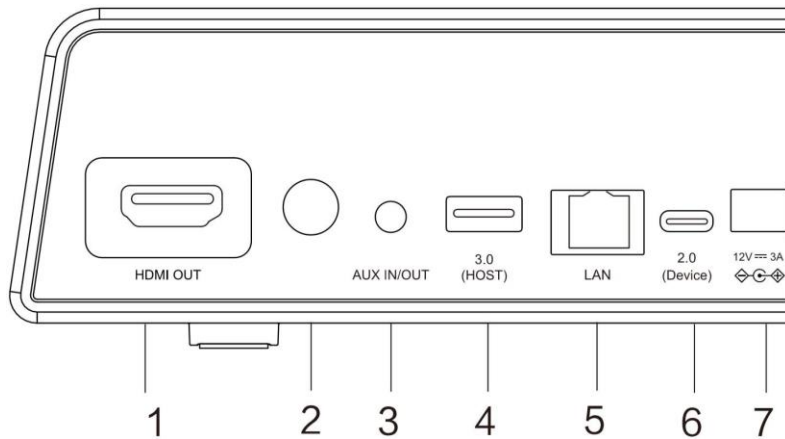

- 1) HDMI OUT: Connect to the devices with HDMI input function
- 2) POWER: Tap to enter energy-saving, press and hold for at least 2 seconds to enter standby mode
- 3) AUX IN/OUT: Used for external audio equipment

- 4) USB 3.0, used for upgrading and connecting with external mouse/keyboard
- 5) LAN: Connect RJ45 terminals
- 6) USB 2.0: Device can be connected to a computer through a USB Type-A to Type-C data cable, providing the computer with camera, microphone and speaker
- 7) DC: Used for 12V power input power supply
- 8) Camera
- 9) Hanging components

## Mounting Options

- 1) Placed directly on the desktop.
- 2) Wall-mounted: Fix the bracket onto the wall with screws, then place the integrated video conferencing terminal onto the bracket.

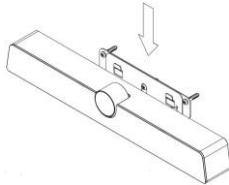

- 3) With Tablet: Fix the bracket onto the supporting bracket with screws, then place the integrated video conferencing terminal onto the bracket.

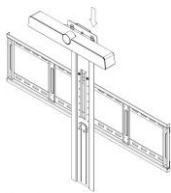

Note: The connection of different samples may slightly differ. Please refer to the actual product.

## Quick Start

- 1) Please use the HDMI cable to connect this product to a display.
- 2) To turn on the device, press the power button on the back of the product or use remote control.
- 3) For the first use, please complete the network connection and device activation during device boot.
- 4) After successful activation, this product should be fully functional.

## Federal Communication Commission Interference Statement

This equipment has been tested and found to comply with the limits for a Class B digital device, pursuant to Part 15 of the FCC Rules. These limits are designed to provide reasonable protection against harmful interference in a residential installation.

This equipment generates, uses, and can radiate radio frequency energy and, if not installed and used in accordance with the instructions, may cause harmful interference to radio communications. However, there is no guarantee that interference will not occur in a particular installation. If this equipment does cause harmful interference to radio or television reception, which can be determined by turning the equipment off and on, the user is encouraged to try to correct the interference by one or more of the following measures:

- Reorient or relocate the receiving antenna.
- Increase the separation between the equipment and receiver.
- Connect the equipment into an outlet on a circuit different from that to which the receiver is connected.
- Consult the dealer or an experienced radio/TV technician for help.

## FCC Caution

This device complies with Part 15 of the FCC Rules. Operation is subject to the following two conditions:

- 1) This device may not cause harmful interference, and
- 2) this device must accept any interference received, including interference that may cause undesired operation.

## IC Radiation Exposure Statement for Canada

This device contains licence-exempt transmitter(s)/receiver(s) that comply with Innovation, Science and Economic Development Canada's licence-exempt RSS(s).

Operation is subject to the following two conditions:

- This device may not cause interference.
- This device must accept any interference, including interference that may cause undesired operation of the device.

## 7668 RF & Power

Frequency Range	Output Power (Max.)
2412 to 2472 MHz	19.17 dBm
5150 to 5250 MHz	19.23 dBm
5725 to 5825 MHz	13.02 dBm

- Antenna Type: PCB
- Antenna Gain: 2.4G Wifi 2.44dBi;5G wifi ( 5150 to 5250 MHz ) 2.02dBi; 5G wifi (5150 to 5250 MHz ) 2.85dBi
- Antenna Impedance: 50 $\Omega$





## 8821 RF & Power

Frequency Range	Output Power (Max.)
2412 to 2472 MHz	18.67 dBm
5150 to 5250 MHz	12.54 dBm
5725 to 5825 MHz	12.44 dBm

- Antenna Type:FPC
- Antenna Gain: 2.4G Wifi 5.95dBi;5G wifi ( 5150 to 5250 MHz ) 3.48dBi; 5G wifi (5150 to 5250 MHz ) 2.32dBi
- Antenna Impedance: 50Ω

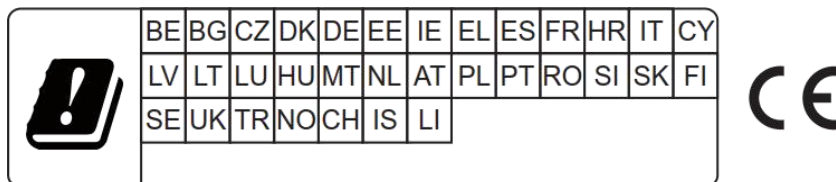
Hereby, LOFT declares that the radio equipment type UC S10 is in compliance with Directive 2014/53/EU.



 This symbol, affixed to the product or its packaging, indicates that the product must not be processed with household waste. It must be brought to an electric and electronic waste collection point for recycling and disposal. By the appropriate disposal of this product you also help in preventing potentially negative consequences for the environment and human health. The recycling of materials helps preserve our natural resources. For further information regarding the recycling of this product, please contact your municipality, local waste disposal centre or the store where the product was purchased.